

# AXIAL DC FAN

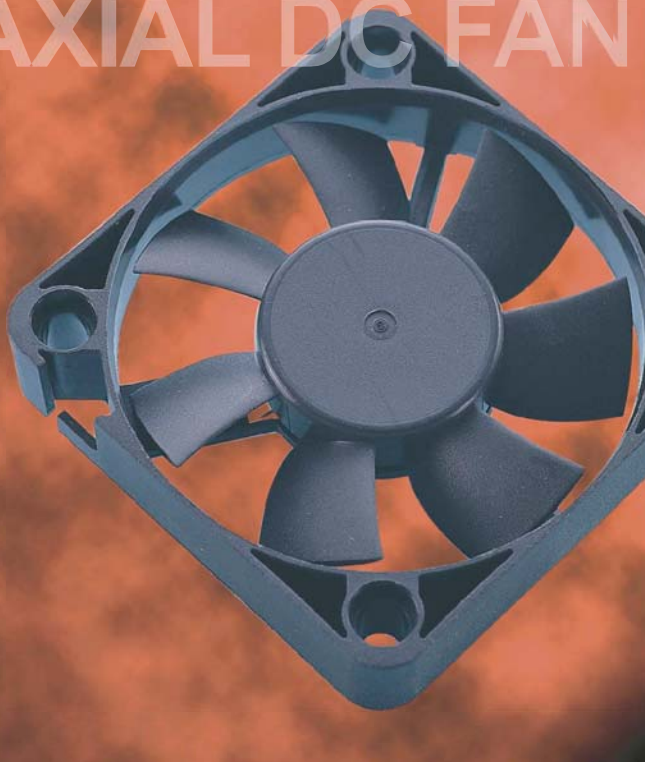

European Thermodynamics Limited  
Intelligent Thermal Management

http://www.etsy.com  
email: info@etsy.com  
26-27 Chartwell Drive Ind Est  
S.Wigston  
Leicester, LE18 2FL, UK

## FD5010 SERIES

### 50x50x10mm

- Airflow: 9.00~13.20 CFM
- Static Pressure: 1.60~4.00 mm-H<sub>2</sub>O
- Blade / Housing: Plastic Material UL 94-0 P.B.T.
- Lead Wire: UL1007 #26 AWG
- Weight: 18g

Model	Bearing	Rated Voltage	Operating Voltage Range	Power Consumption	Rated Speed	Max. Airflow	Max. Static Pressure	Noise	Life	Weight
		VDC	VDC	W	RPM	CFM	mm-H <sub>2</sub> O	dB(A)	Hour	g
FD0550105B-2N	2B	5	4~7	0.85	4,600	10.70	2.60	31.0	80,000	18
FD0550107B-2N	2B		4~7	1.20	5,200	12.00	3.00	34.0	75,000	18
FD1250103B-2A	2B	12	7~17	1.08	4,000	9.60	1.70	28.5	80,000	18
FD1250105B-2A	2B		7~17	1.44	4,600	10.70	2.60	31.0	80,000	18
FD1250107B-2A	2B		7~17	1.68	5,200	12.00	3.00	34.0	75,000	18
FD1250109B-2A	2B		7~17	2.16	6,000	13.20	4.00	38.0	75,000	18

● 2B: 2-ball bearing BS: 1-ball 1-sleeve bearing S: sleeve bearing

**Voltage Available**

05 12 24 48 53

**Bearing System Available**

2B BS S

**Function Available**

N A I F R Q S T M V C P W

### PERFORMANCE P-Q CURVE

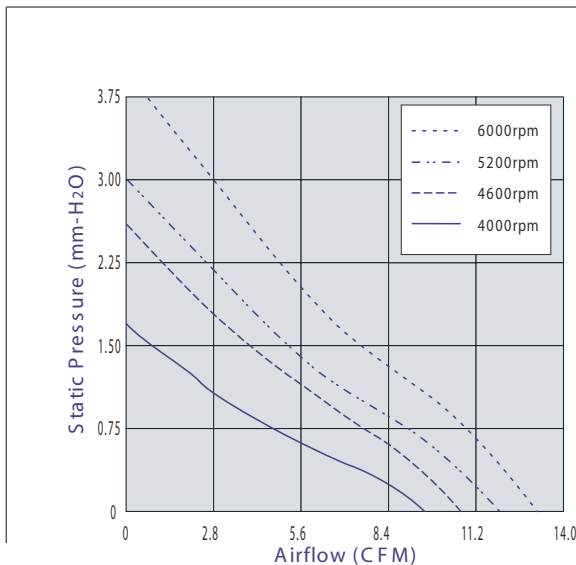

### OUTLINE DIMENSIONS

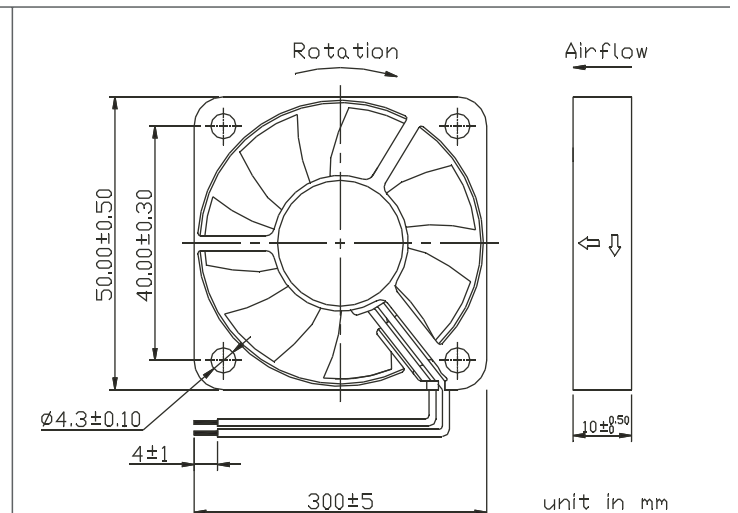

Customized Specifications are designed accordingly.  
Specifications are subject to change without notice. Please visit Y.S. TECH web site at <http://www.ys.tech.com.tw> for updated information.

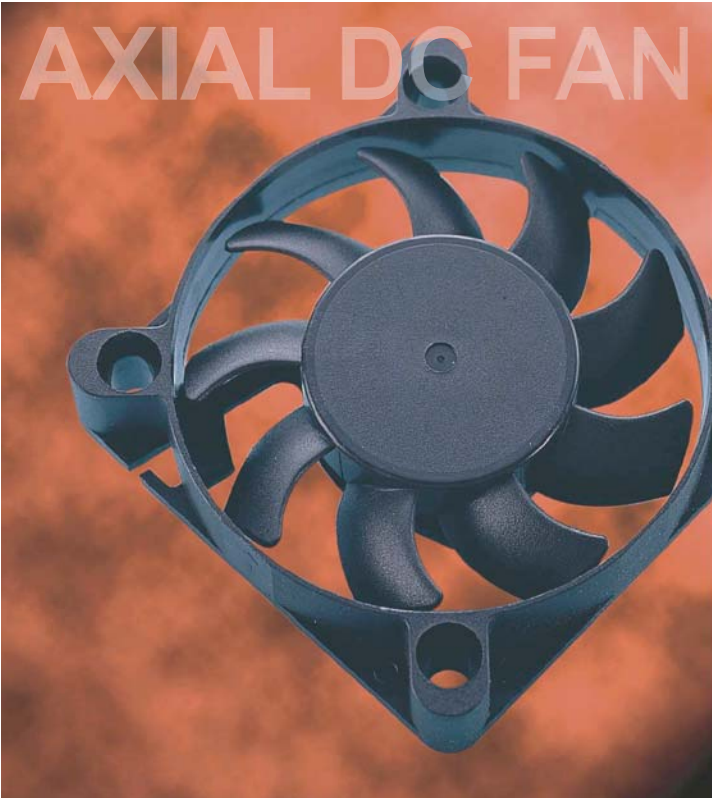

<http://www.etedyn.com>  
 email: [info@etedyn.com](mailto:info@etedyn.com)  
 26-27 Chartwell Drive Ind Est  
 S.Wigston  
 Leicester, LE18 2FL, UK

# FD5011 SERIES

## 50x50x10mm

- Airflow: 9.50~12.50 CFM
- Static Pressure: 1.90~3.50 mm-H<sub>2</sub>O
- Blade / Housing: Plastic Material UL 94-0 P.B.T.
- Lead Wire: UL1007 #26 AWG
- Weight: 20 g

Model	Bearing	Rated Voltage	Operating Voltage Range	Power Consumption	Rated Speed	Max. Airflow	Max. Static Pressure	Noise	Life	Weight
		VDC	VDC	W	RPM	CFM	mm-H <sub>2</sub> O	dB(A)	Hour	g
FD1250113B-1A	BS	12	7~17	1.08	4,000	9.50	1.90	26.5	50,000	20
FD1250113B-1N	BS		7~17	1.08	4,000	9.50	1.90	26.5	50,000	20
FD1250115B-1A	BS		7~17	1.32	4,800	11.00	2.70	30.5	50,000	20
FD1250115B-1N	BS		7~17	1.32	4,800	11.00	2.70	30.5	50,000	20
FD1250117B-1A	BS		7~17	1.56	5,400	12.50	3.50	32.0	50,000	20
FD1250117B-1N	BS		7~17	1.56	5,400	12.50	3.50	32.0	50,000	20

● 2B: 2-ball bearing BS: 1-ball 1-sleeve bearing S: sleeve bearing

### Voltage Available

05 12 24 48 53

### Bearing System Available

2B BS S

### Function Available

N A I F R Q S T M V C P W

### PERFORMANCE P-Q CURVE

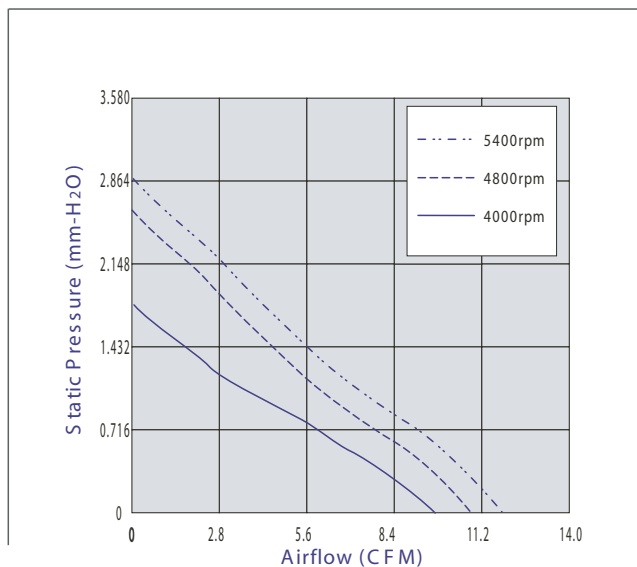

### OUTLINE DIMENSIONS

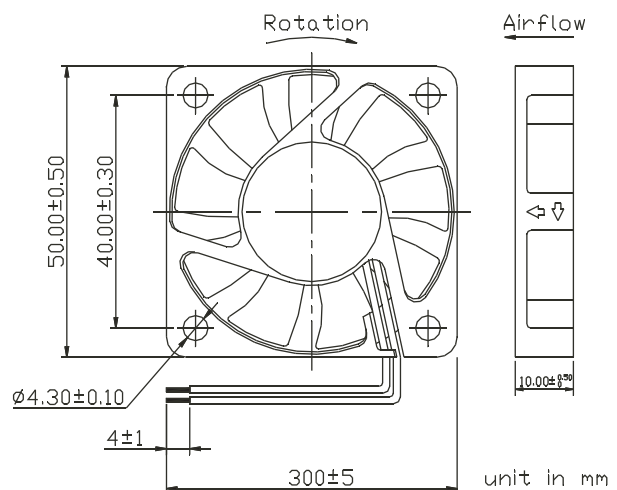

Customized Specifications are designed accordingly. Specifications are subject to change without notice. Please visit Y.S. TECH web site at <http://www.ystech.com.tw> for updated information.